

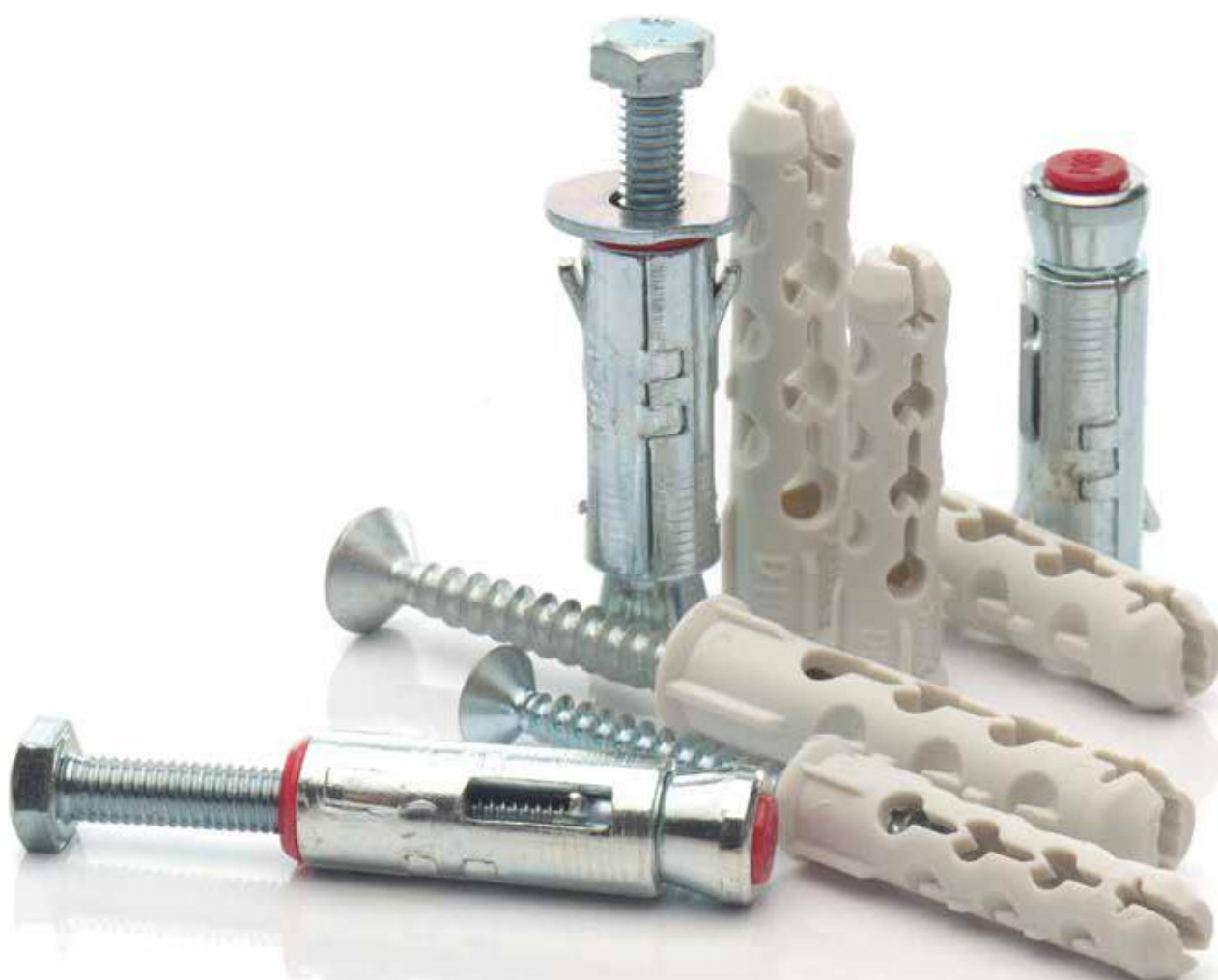

FIXAÇÃO  
*FISSAGGI*

**ELECTRICOL**



**Tabela de Preços**  
**2/2023**

# GUIDA RAPIDA FISSAGGI LEGGERI





## QUICK GUIDE TO LIGHT FIXINGS

Per facilitare e soprattutto per rendere il fissaggio più rapido e sicuro, la guida rapida fornisce la soluzione a qualsiasi problema o dubbio relativo al fissaggio. I fissaggi leggeri sono versatili e idonei per numerose applicazioni su supporti diversi. Le tabelle tengono conto di una serie di fattori, quali materiali di supporto, carichi applicati, tipologia dell'installazione, tipologie di ancorante, modi di foratura, e profondità di ancoraggio, tutti indispensabili per determinare il corretto tassello o ancorante.

*To facilitate and above all to make fixings quicker and safer, the quick guide provides the solution to any problem or doubt related to fixing. Light fixings are versatile and suitable for several applications on different supports. The tables take into account a number of factors, including support materials, applied loads, type of installation, types of anchor, drilling methods, and anchoring depth, all essential for determining the correct anchor or dowel.*

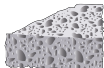
### TIPOLOGIA DI MATERIALI

#### TYPE OF MATERIALS

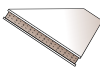
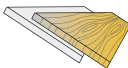
COMPATTI SOLID			FORATI PERFORATED		A BASSA RESISTENZA LOW RESISTANCE		
Mattoni pieni Solid bricks	Calcestruzzo Concrete	Pietra naturale Natural stone	Mattone forato Perforated brick	Blocchi forati Perforated blocks	Calcestruzzo cellulare Cellular concrete	Cartongesso Plasterboard	Pannelli/lastre Panels/slabs
							

**UNIVERSALI**  
*UNIVERSAL*

pag.

	Brick	Concrete	Insulation	Brick with Mortar	Brick	Concrete	Brick	Brick	
 Super-V EVO	●	●	●	●	●	●	○	○	253
 TNU	●	●	●	●	●	●	○	○	258
 TN	●	●	●	●	●	●	○	○	260
 TM	●	●	●	○	○				263

**PER SUPPORTI VUOTI**  
*FOR HOLLOW MATERIALS*

 TNV	○	○	○	●	●	●	●	○	266
 AG				●	○		●	●	268
 AM				●	○		●	●	270

**CARTONGESSO**  
*PLASTERBOARD*

 VP							●		273
 VM							●		275

● Applicazione idonea  
*Suitable application*

○ Parzialmente indicato  
*Partially suitable application*

## TASSELLI UNIVERSALI SUPER-V EVO

### SUPER-V EVO UNIVERSAL WALL PLUGS

L'innovativo tassello in nylon **Super-V EVO**, grazie alla sua capacità di adattarsi alle diverse tipologie di materiali, consente di ottenere valori di tenuta estremamente elevati in perfetta sicurezza. Il particolare profilo interno e il tecnopolimero utilizzato consentono l'impiego di viti per legno, per truciolari e autofilettanti.

Il design è stato accuratamente studiato allo scopo di evitare che in fase di installazione il tassello penetri troppo o ruoti all'interno del foro.

Il tassello **Super-V EVO** è corredato di una vasta gamma di viti con filettatura per truciolare, di forme e dimensioni diverse, per risolvere qualsiasi problema di fissaggio nei diversi campi di utilizzo e per garantire prestazioni altamente affidabili.

**Super V EVO**

*Thanks to its ability to adapt to different types of materials, the innovative **Super-V EVO** nylon plug allows extremely high holding with all-around security.*

*The particular inner profile and the technopolymer used allows the use of wood, chipboard and self-tapping screws.*

*The design has been thoroughly engineered to prevent the plug from penetrating too much or rotating inside the hole during installation.*

*The **Super-V EVO** plug comes complete with a wide range of screws for chipboard, in different shapes and sizes, to solve any fixing issues in the various areas of use and to ensure highly reliable performance.*

#### **Materiale tassello:**

poliammide ad alta resistenza, colore grigio

**Materiale vite:** acciaio zincato

**Tipo di installazione:** non passante

#### **Plug material:**

high resistance grey polyamide

**Screws material:** galvanized steel

**Type of installation:** non-through

### SEQUENZA DI FISSAGGIO • FIXING STEPS

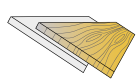
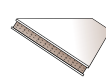
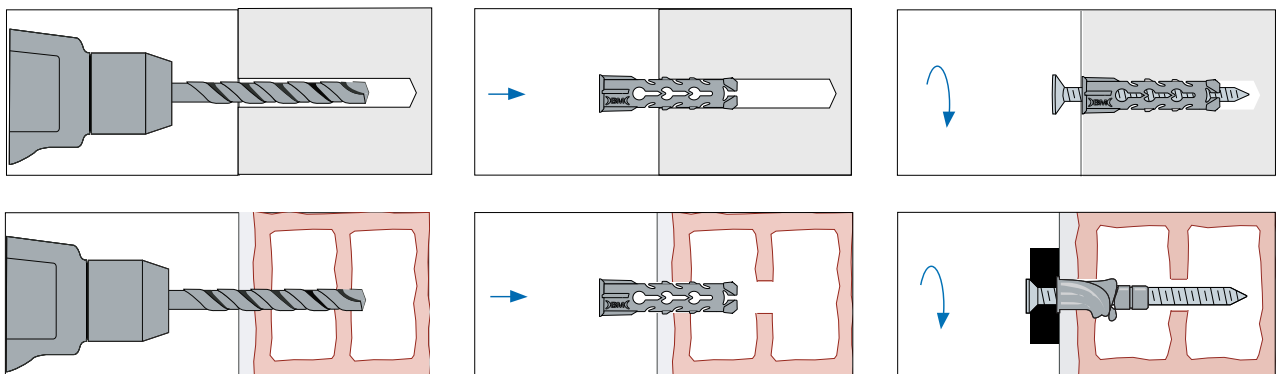



## TASSELLO IN NYLON

NYLON WALL PLUG

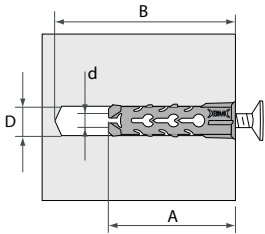

Articolo Code	D	A	B	d	
<b>F0001</b>	5	25	35	3 ÷ 4	
<b>F0002</b>	6	30	40	4 ÷ 5	100/4000
<b>F0003</b>	8	40	50	4,5 ÷ 6	
<b>F0004</b>	10	50	70	6 ÷ 7	50/2000
<b>F0005</b>	12	60	80	7 ÷ 8	25/1000

## CON VITE A TESTA SVASATA PIANA PZ

WITH FLAT COUNTERSUNK HEAD PZ SCREW

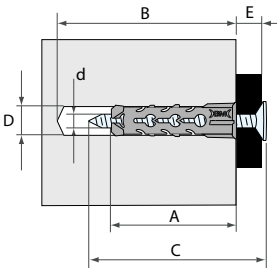

Articolo Code	D	A	B	E max	d x C	
<b>F0011</b>	5	25	35	5	4 x 30	100/3000
<b>F0012</b>	6	30	40	10	4,5 x 40	
<b>F0013</b>	8	40	50	10	5 x 50	50/1500
<b>F0014</b>	10	50	70	10	6 x 60	25/750

## CON VITE A TESTA CILINDRICA FLANGIATA PH

WITH CYLINDRIC FLANGED HEAD PH SCREW

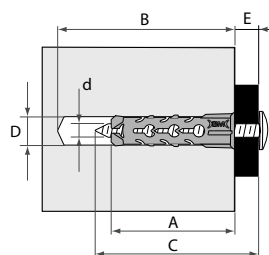

Articolo Code	D	A	B	d x C	E max	
<b>F0021</b>	5	25	35	4 x 30	5	100/3000
<b>F0022</b>	6	30	40	4,5 x 40	10	
<b>F0023</b>	8	40	50	5 x 50	10	50/1500

**CON VITE A TESTA ESAGONALE**  
WITH HEXAGONAL HEAD SCREW

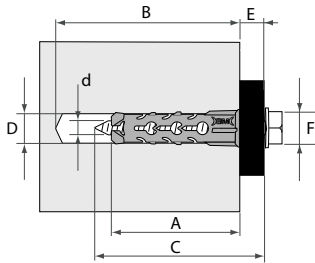

Articolo Code	D	A	B	d x C	E max	F
<b>F0073</b>	8	40	50	5,5 x 45	5	10
<b>F0074</b>	10	50	65	6,5 x 60	10	10
<b>F0075</b>	12	60	75	7,5 x 70	10	13

Super **EVO**

**CON OCCHIOLO APERTO**  
WITH ROUND HOOK

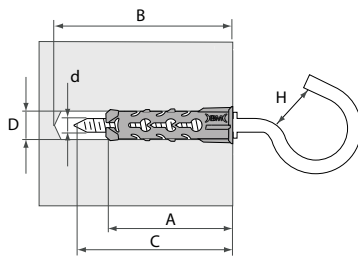

Articolo Code	D	A	B	d x C	H
<b>F0032</b>	6	30	40	4,5 x 35	10

Super **EVO**

**CON OCCHIOLO CHIUSO**  
WITH EYE HOOK

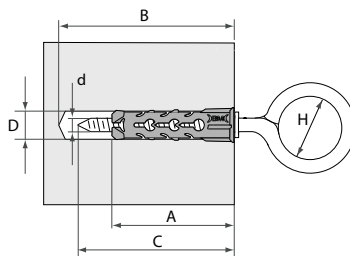

Articolo Code	D	A	B	d x C	H
<b>F0052</b>	6	30	40	4,5 x 35	13

Super **EVO**

**CON GANCIO CORTO**  
WITH SHORT HOOK

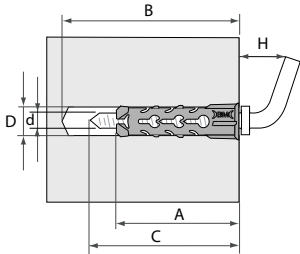

Articolo Code	D	A	B	d x C	H	
<b>F0062</b>	6	30	40	4,5 x 35	10	25/750

SuperV EVO

**CON GANCIO MEDIO**  
WITH L-HOOK

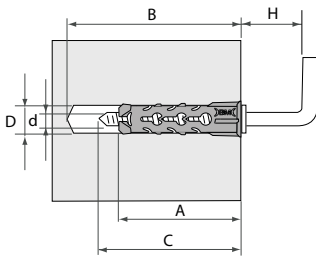

Articolo Code	D	A	B	d x C	H	
<b>F0042</b>	6	30	40	4,5 x 35	14	25/750

SuperV EVO

**CON VITE A TESTA FILETTATA**  
WITH THREADED HEAD SCREW

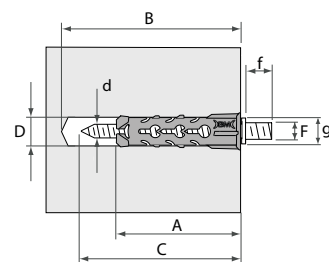

Articolo Code	D	A	B	d x C	g	F	f	
<b>F0092</b>	6	30	40	4,5 x 35	8,5	M6	6	25/750
<b>F0093</b>	8	40	50	5 x 45	11	M8	8	

SuperV EVO

**ASSORTIMENTI · KIT 400 TASSELLI CON VITE A TESTA SVASATA PIANA PZ**  
*ASSORTMENTS · 400 PLUGS WITH FLAT COUNTERSUNK HEAD PZ SCREW*



Articolo Code	D	A	B	d x C	E max	
<b>F9942</b>	5	25	35	4 x 30	5	1/10
<b>F9940</b>	6	30	40	4,5 x 40	10	

Super **EVO**

**ESPOSITORE PV**  
*IN-STORE DISPLAY UNIT*



Articolo Code	Descrizione Description
<b>F9941</b>	Espositore punto vendita. Capacità 32 kit. <i>In-store display unit. 32 kit capacity.</i>

Super **EVO**

# TASSELLI UNIVERSALI TNU

## UNIVERSAL WALL PLUGS TNU

È un tassello universale in nylon che assicura un eccellente ancoraggio, specialmente nelle intercapedini dei materiali vuoti. La particolare forma del tassello garantisce la perfetta tenuta grazie alla corretta espansione e all'apertura a ombrello. Le alette laterali e lo speciale collare impediscono al tassello di ruotare sul proprio asse, mentre l'apertura longitudinale assicura un'ottima tenuta sia nei materiali pieni, per espansione, sia nelle intercapedini grazie alla flessione della parte centrale. Il profilo interno del tassello consente una rapida presa alla parte terminale della vite, e di conseguenza un'espansione immediata.

# TNU

*It is a universal nylon wall plug that provides excellent anchorage especially in hollow materials. The special shape of the wall plug ensures perfect hold thanks to the correct expansion and the umbrella-like opening. The side fins and the special collar prevent the wall plug from rotating on its axis while the lengthwise opening ensures excellent hold both in solid materials by expansion and in hollow spaces due to the bending of the central part. The internal profile of the plug allows the end of the screw to grip quickly, causing an immediate expansion.*

**Materiale tassello:**

nylon ad alta resistenza, colore grigio

**Materiale vite:** acciaio zincato

**Tipo di installazione:** non passante

**Plug material:**

high resistance grey nylon

**Screws material:** galvanized steel

**Type of installation:** non-through

### SEQUENZA DI FISSAGGIO • FIXING STEPS

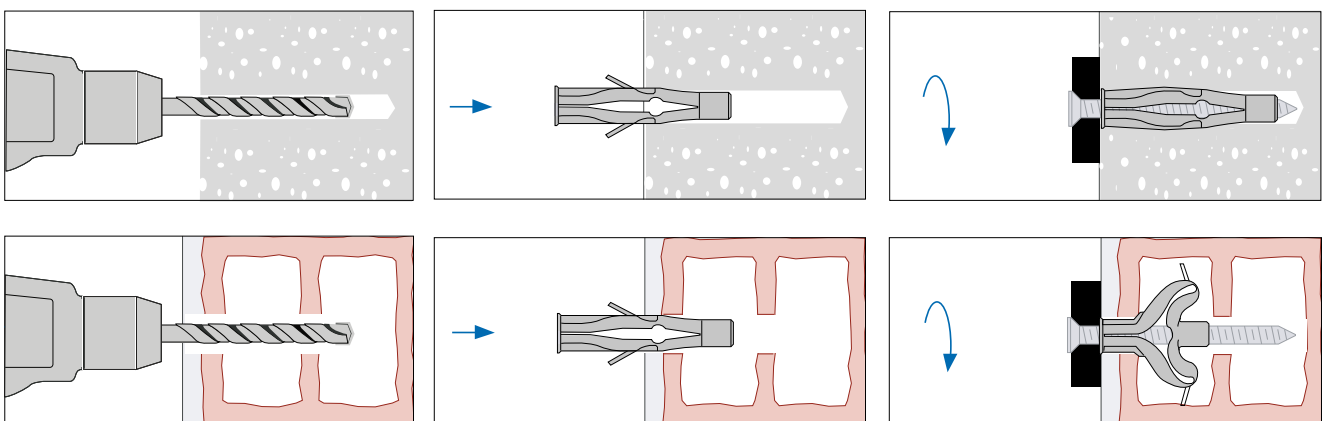

**TASSELLO IN NYLON**  
 NYLON WALL PLUG

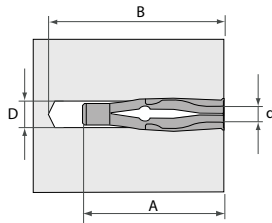

Articolo Code	D	A	B	d	
<b>F0201</b>	6	35	50	3,5 ÷ 4	100/5000
<b>F0202</b>	8	50	60	4 ÷ 5	100/10000
<b>F0203</b>	10	60	75	5 ÷ 6	100/1200

TNU

**CON VITE A TESTA SVASATA PIANA PZ**  
 WITH FLAT COUNTERSUNK HEAD PZ SCREW

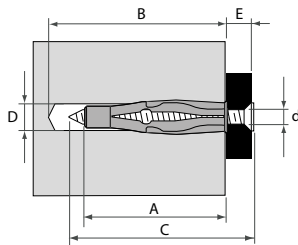
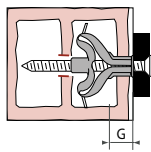

Articolo Code	D	A	B	d x C	E max	G min	
<b>F0211</b>	6	35	50	3,5 x 45	10	5	100/2000
<b>F0212</b>	8	50	60	4,5 x 60	10	10	
<b>F0213</b>	10	60	75	6 x 80	10	10	100/1000

TNU

# TASSELLI UNIVERSALI TN

## UNIVERSAL WALL PLUGS TN

Progettati per fissaggi leggeri, i tasselli universali TN sono caratterizzati da una vasta gamma di accessori premontati in acciaio zincato. La particolare forma del tassello, dotato di alette laterali che ne impediscono la rotazione, garantisce l'efficacia dell'espansione.

Il cono in ottone che viene richiamato avvitando la vite ne determina l'espansione. Le aperture longitudinali permettono un'aderenza ottimale anche in caso di materiali non compatti.



*Designed for lightweight fixings, universal TN wall plugs feature a wide range of pre-assembled galvanized steel accessories. The particular shape of the plug, provided with side fins that prevent rotation, guarantees an effective expansion. The brass cone that is drawn in by screwing the screw determines the expansion. The lengthwise openings allow for optimal adhesion even with hollow materials.*

**Materiale tassello:**

nylon ad alta resistenza, colore grigio

**Materiale cono:** ottone

**Materiale vite:** acciaio zincato

**Tipo di installazione:** non passante

**Plug material:**

high resistance grey nylon

**Cone material:** brass

**Screws material:** galvanized steel

**Type of installation:** non-through

### SEQUENZA DI FISSAGGIO • FIXING STEPS

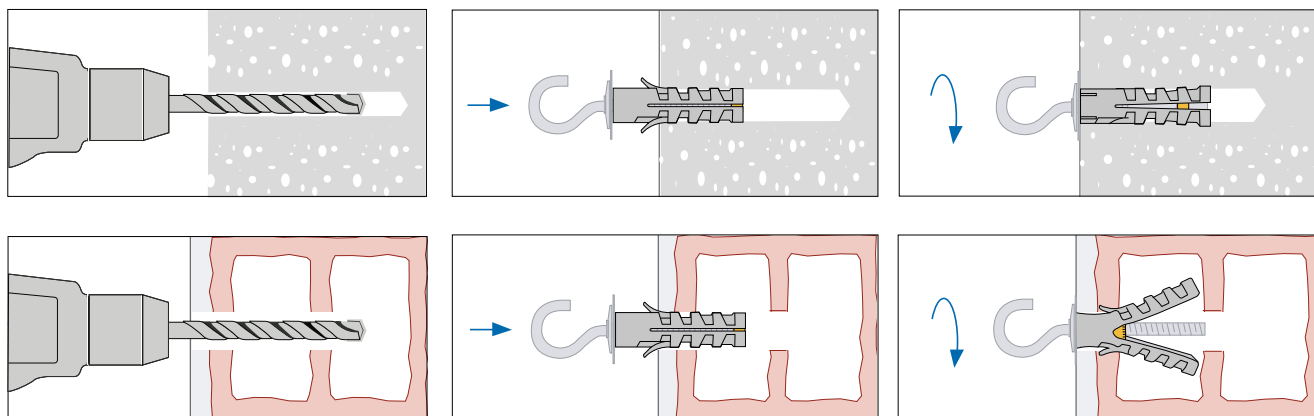

**CON VITE T.S.C. TAGLIO COMBINATO**  
 WITH RAISED HEAD SCREW

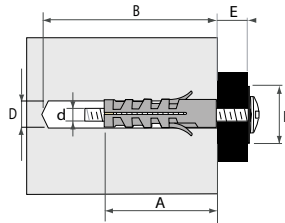

Articolo Code	D	A	B	d	I	E max	
<b>F0311</b>	9	40	50	M4	20	10	100/1000
<b>F0312</b>	12	45	55	M5	24	10	100/800

TN

**CON OCCHIOLO APERTO**  
 WITH ROUND HOOK

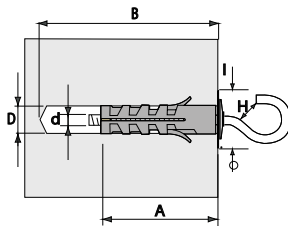

Articolo Code	D	A	B	d	I	H	
<b>F0331</b>	9	40	50	M4	20	8	100/800
<b>F0332</b>	12	45	55	M5	24	8,8	50/500

TN

**CON OCCHIOLO CHIUSO**  
 WITH EYE HOOK

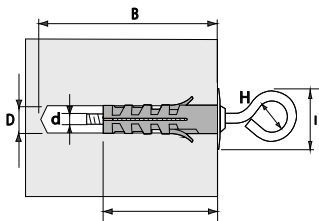

Articolo Code	D	A	B	d	I	H	
<b>F0351</b>	9	40	50	M4	20	13	100/800
<b>F0352</b>	12	45	55	M5	24	14	50/500

TN



**CON GANCIO CORTO**  
WITH SHORT HOOK

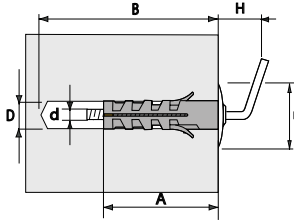

Articolo Code	D	A	B	d	I	H	
<b>F0361</b>	9	40	50	M4	20	10	100/800
<b>F0362</b>	12	45	55	M5	24	12	

TN

**CON GANCIO MEDIO**  
WITH L-HOOK

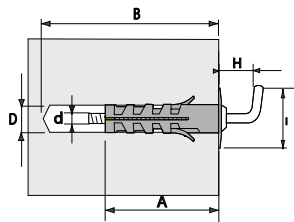

Articolo Code	D	A	B	d	I	H	
<b>F0341</b>	9	40	50	M4	20	14	100/800
<b>F0342</b>	12	45	55	M5	24	16	

TN

**CON DOPPIO DADO**  
WITH DOUBLE NUT

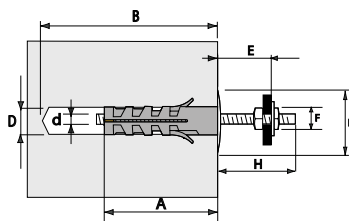

Articolo Code	D	A	B	d	I	E max	H	F	
<b>F0381</b>	9	40	50	M4	20	35	35	7	100/800
<b>F0382</b>	12	45	55	M5	24	40	40	8	50/400

TN

## ANCORANTI TM

### HEAVY DUTY TM ANCHORS

Ideali per fissaggi leggeri, gli ancoranti TM sono caratterizzati da una vasta gamma di accessori premontati in acciaio zincato. Il cono in ottone che viene richiamato avvitando la vite ne determina l'espansione, mentre le alette laterali ne impediscono la rotazione. L'efficacia dell'espansione è garantita dalle schermature del tassello.

*Designed for lightweight fixings, heavy duty TM anchors feature a wide range of pre-assembled galvanized steel accessories. The brass cone that is drawn in by screwing the screw determines the expansion of the anchor, while side fins prevent rotation. The shielding of the plug guarantees an effective expansion.*

**Materiale tassello e viti:** acciaio zincato  
**Materiale cono:** ottone  
**Tipo di installazione:** non passante

**Plug and screw material:** galvanized steel  
**Cone material:** brass  
**Type of installation:** non-through

#### SEQUENZA DI FISSAGGIO • FIXING STEPS

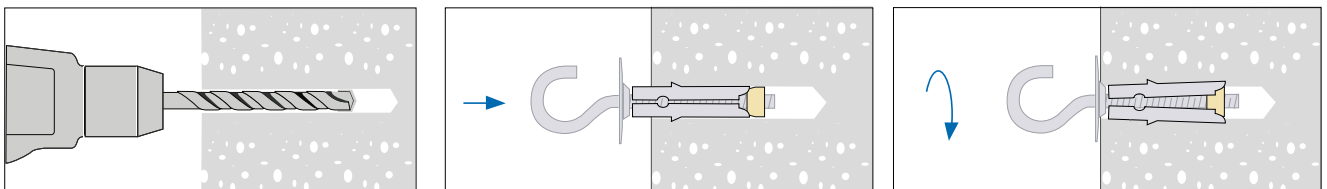

### CON VITE T.S.C. TAGLIO COMBINATO

WITH RAISED HEAD SCREW

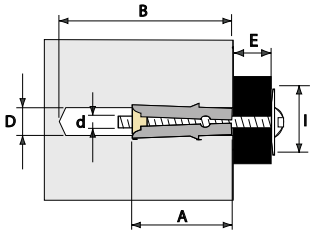

Articolo Code	D	A	B	d	I	E max	
<b>F0411</b>	8	40	50	M4	20	10	100/1000
<b>F0412</b>	9	45	55	M5	24	10	100/800

TM

### CON OCCHIOLO APERTO

WITH ROUND HOOK

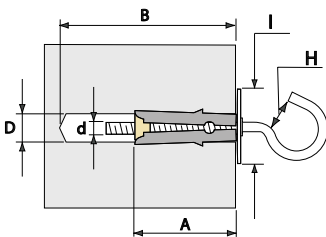

Articolo Code	D	A	B	d	I	H	
<b>F0431</b>	8	40	50	M4	20	8	100/800
<b>F0432</b>	9	45	55	M5	24	8,5	50/500

TM

### CON OCCHIOLO CHIUSO

WITH EYE HOOK

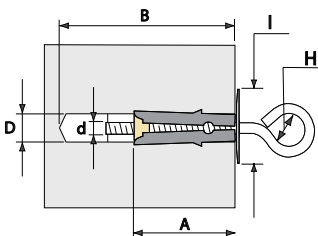

Articolo Code	D	A	B	d	I	H	
<b>F0451</b>	8	40	50	M4	20	13	100/800
<b>F0452</b>	9	45	55	M5	24	14	50/500

TM

**CON GANCIO CORTO**  
WITH SHORT HOOK

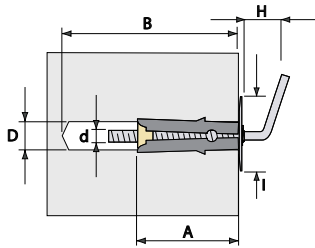

Articolo Code	D	A	B	d	I	H	
<b>F0461</b>	8	40	50	M4	20	9	100/800
<b>F0462</b>	9	45	55	M5	24	10	100/100

TM

**CON GANCIO MEDIO**  
WITH L-HOOK

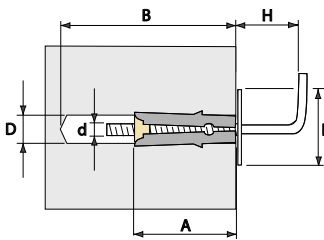

Articolo Code	D	A	B	d	I	H	
<b>F0441</b>	8	40	50	M4	20	12	100/800
<b>F0442</b>	9	45	55	M5	24	15	

TM

**CON DOPPIO DADO**  
WITH DOUBLE NUT

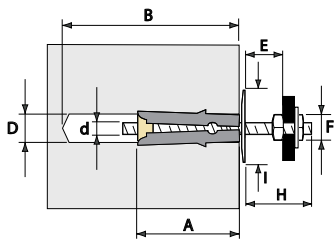

Articolo Code	D	A	B	d	I	E max	H	F	
<b>F0481</b>	8	40	50	M4	20	25	35	7	100/800
<b>F0482</b>	9	45	55	M5	24	30	40	8	50/400

TM

## TASSELLI PER SUPPORTI VUOTI TNV

### TNV WALL PLUGS FOR HOLLOW MATERIALS

I tasselli per supporti vuoti TNV sono appositamente studiati per garantire un eccellente ancoraggio nelle intercapedini dei materiali vuoti.

La forma del tassello produce una particolare deformazione che garantisce una perfetta tenuta.

Le alette laterali e lo speciale collare impediscono al tassello di ruotare sul proprio asse.

*TNV wall plugs for hollow materials are specially designed to guarantee an excellent anchorage in the dry spaces of hollow materials.*

*The shape of the wall plug produces a special deformation that ensures a perfect hold.*

*The lateral fins and the special collar prevent the plug from rotating on its own axis.*

**Materiale tassello:**

nylon ad alta resistenza, colore grigio

**Materiale vite:** acciaio zincato

**Tipo di installazione:** non passante

**Plug material:**

high resistance grey nylon

**Screws material:** galvanized steel

**Type of installation:** non-through

#### SEQUENZA DI FISSAGGIO • FIXING STEPS

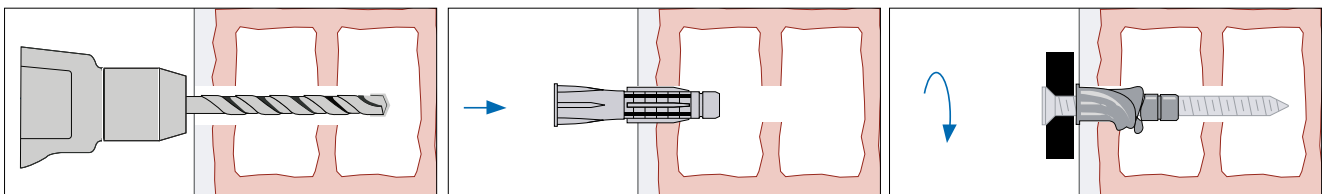

**TASSELLO IN NYLON**  
 NYLON WALL PLUG

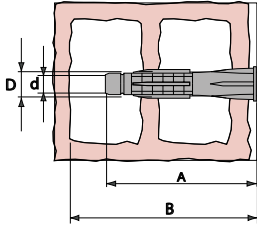

Articolo Code	D	A	B	d	
<b>F0101</b>	6	36	55	3,5 ÷ 4	100/3600
<b>F0102</b>	8	50	65	4,5 ÷ 5	100/2400
<b>F0103</b>	10	60	75	5	100/1200

TNV

**CON VITE A TESTA SVASATA PIANA PZ**  
 WITH FLAT COUNTERSUNK HEAD PZ SCREW

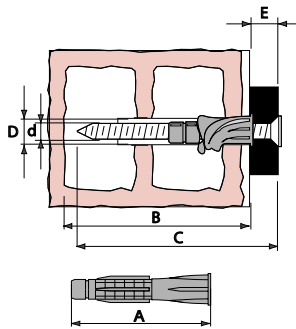

Articolo Code	D	A	B	d x C	E	
<b>F0111</b>	6	36	55	3,5 x 50	5	100/2400
<b>F0112</b>	8	50	65	4,5 x 50	5	100/1200
<b>F0113</b>	10	60	75	5 x 70	5	100/900

TNV

## ANCORE A GRAVITÀ AG

### AG GRAVITY TOGGLE BOLTS

L'ancora a gravità AG è provvista di una traversina ribaltabile che garantisce un'ottima tenuta in verticale. È ideale per fissaggi leggeri e per materiali forati con cavità tecniche poco profonde. La barra filettata consente la regolazione della profondità, bilanciando eventuali differenze di spessore nei muri. Il particolare meccanismo con la traversina ribaltabile ne impedisce lo sgancio accidentale.

*AG gravity toggle anchor is equipped with a hinged bearing element that guarantees an excellent vertical hold. It is ideal for light fixings and perforated materials with shallow technical cavities. The threaded rod allows for depth adjustment, balancing any differences in the walls' thickness. The unique mechanism with the hinged bearing element prevents accidental release.*

**Materiale:** acciaio zincato  
**Tipo di installazione:** passante

**Material:** galvanized steel  
**Type of installation:** through

#### SEQUENZA DI FISSAGGIO · FIXING STEPS

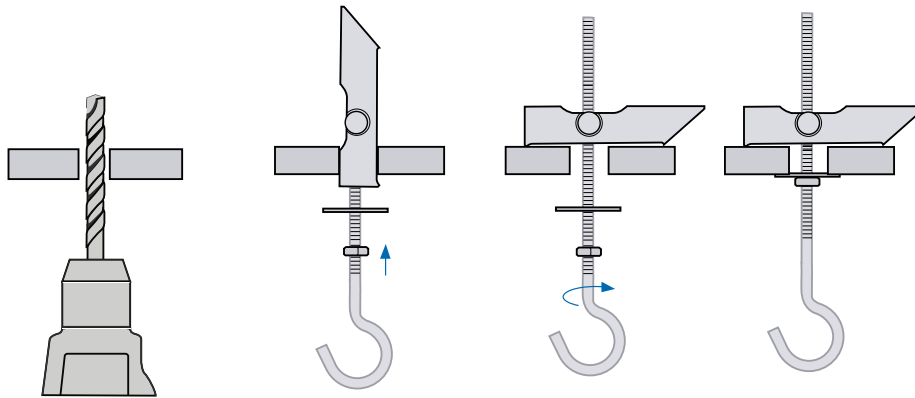

**CON OCCHIOLO APERTO**  
WITH ROUND HOOK

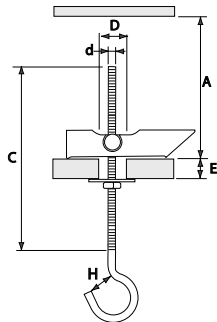

Articolo Code	D	d x C	E max	H	A min	
<b>F1136</b>	16	M6 x 70	31	12	67	100/100

AG

**CON BARRA FILETTATA E DOPPIO DADO**  
WITH THREADED ROD AND DOUBLE NUT

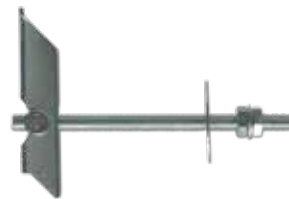
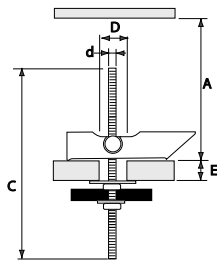

Articolo Code	D	d x C	E max	A min	
<b>F1186</b>	16	M6 x 100	31	67	100/100

AG



## ANCORE A MOLLA AM

### AM SPING TOGGLES

L'ancora a molla AM è ideale per fissaggi leggeri in verticale. Specifica per materiali forati con cavità tecniche poco profonde, è dotata di una barra filettata che consente la regolazione della profondità, bilanciando eventuali differenze di spessore dei muri. Il particolare meccanismo a molla ne impedisce lo sgancio accidentale.

*The AM spring toggle is ideal for vertical light fixings and for perforated materials with shallow technical cavities. The threaded rod allows for depth adjustment, balancing any differences in the walls' thickness. The unique spring mechanism prevents accidental release.*

**Materiale:** acciaio zincato  
**Tipo di installazione:** non passante

**Material:** galvanized steel  
**Type of installation:** non-through

#### SEQUENZA DI FISSAGGIO · FIXING STEPS

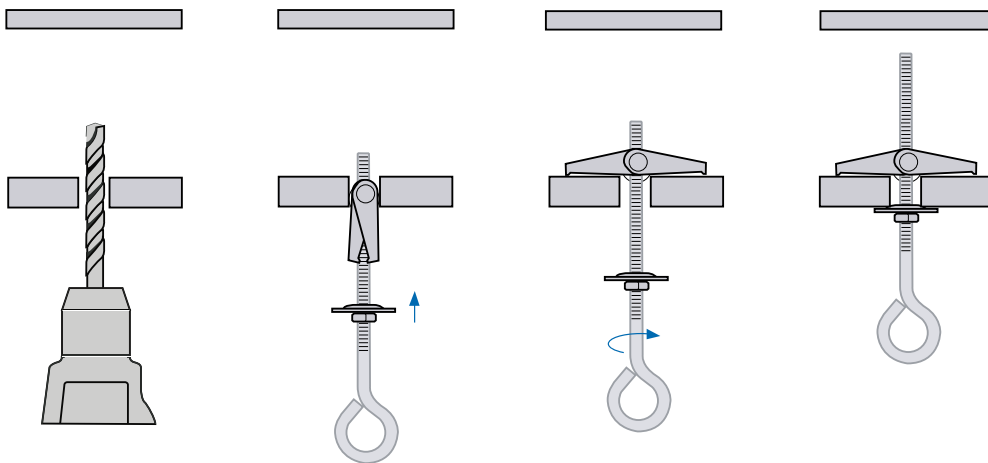

**CON VITE A TESTA SVASATA PH**  
 WITH COUNTERSUNK HEAD PH SCREW

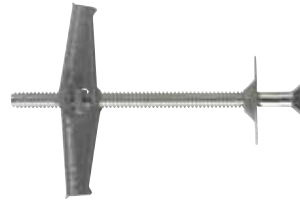
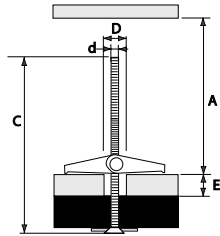

Articolo Code	D	d x C	E max	A min	
<b>F1014</b>	14	M4 x 90	30	34	100/100

AM

**CON OCCHIOLO APERTO**  
 WITH ROUND HOOK

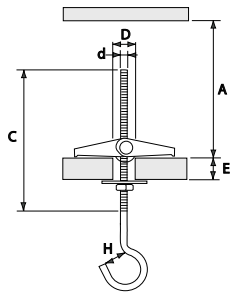

Articolo Code	D	d x C	E max	H	A min	
<b>F1034</b>	14	M4 x 65	30	14	34	100/100

AM

**CON OCCHIOLO CHIUSO**  
*WITH EYE HOOK*

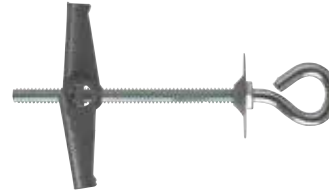
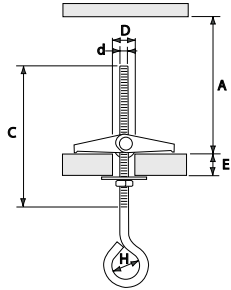

Articolo Code	D	d x C	E max	A min	H	
<b>F1054</b>	14	M4 x 65	30	34	14	100/100

AM

**CON BARRA FILETTATA E DOPPIO DADO**  
*WITH THREADED ROD AND DOUBLE NUT*

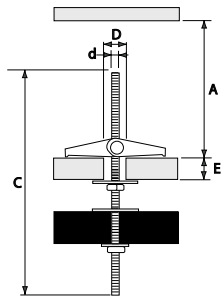

Articolo Code	D	d x C	A min	E max	
<b>F1084</b>	14	M4 x 95	34	30	100/100

AM

## TASSELLO PER CARTONGESSO VP

### VP PLASTERBOARD ANCHOR

Il tassello VP in poliammide è ideale per fissaggi leggeri su cartongesso.  
 Grazie alle ridotte dimensioni non ha bisogno di grandi spazi vuoti sul retro della parete di cartongesso.  
 Il tassello VP non è adatto per fissaggi su pannelli di fibrocemento e su pannelli di cartongesso con rivestimenti sintetici.  
 Per applicazioni su pannelli di spessore superiore a 15 mm è necessario fare un pre-foro.



*VP polyamide anchors are ideal for light fixings on plasterboard.  
 Thanks to their small size, there is no need for a large air space behind the plasterboard wall.  
 It is not suitable for fixings on fibre-cement panels and on plasterboard with synthetic coatings.  
 For applications on panels over 15 mm thick, you need to drill a pilot hole.*

**Materiale tassello:** poliammide ad alta resistenza

**Materiale vite:** acciaio zincato

**Tipo di installazione:** non passante

**Plug material:** high resistance polyamide

**Screws material:** galvanized steel

**Type of installation:** non-through

### SEQUENZA DI FISSAGGIO • FIXING STEPS

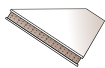
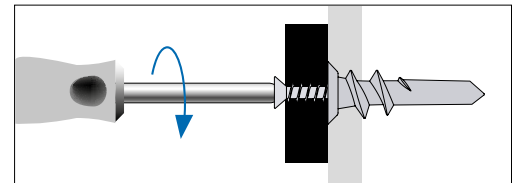
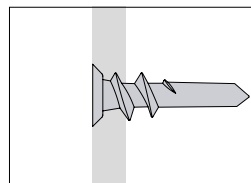
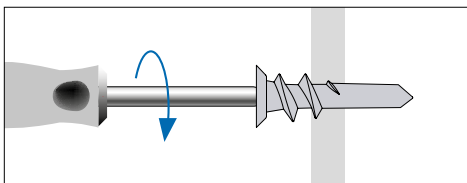

**CON VITE A TESTA SVASATA PIANA PZ**  
 WITH FLAT COUNTERSUNK HEAD PZ SCREW

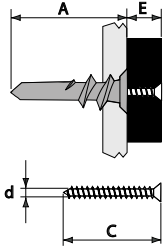

Articolo Code	A	d x C	E max	
<b>F1311</b>	33	4,5 x 35	12	100/2000

VP

## TASSELLO PER CARTONGESSO VM

### VM PLASTERBOARD ANCHOR

Il tassello VM in metallo è ideale per fissaggi su pannelli e lastre in cartongesso. Grazie alle ridotte dimensioni non ha bisogno di grandi spazi vuoti sul retro della parete di cartongesso. Il tassello VM non è adatto per fissaggi su pannelli di fibrocemento e su pannelli di cartongesso con rivestimenti sintetici. Per applicazioni su pannelli di spessore superiore a 15 mm è necessario fare un pre-foro.

*The VM metal anchor is ideal for fixings on plasterboard panels and sheets. Thanks to its small size, there is no need for a large air space behind the plasterboard wall. It is not suitable for fixings on fibre-cement panels and on plasterboard with synthetic coatings. For applications on panels over 15 mm thick, you need to drill a pilot hole.*

**Materiale tassello:** zama  
**Materiale vite:** acciaio zincato.  
**Tipo di installazione:** non passante

**Plug material:** zinc alloy  
**Screws material:** galvanized steel  
**Type of installation:** non-through

#### SEQUENZA DI FISSAGGIO • FIXING STEPS

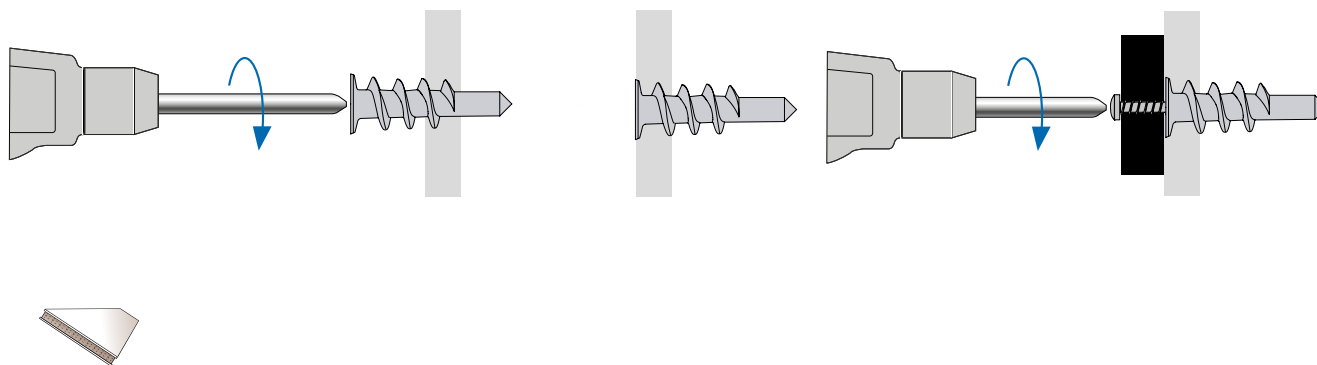

**CON VITE A TESTA CILINDRICA PZ**  
*WITH FLAT HEAD PZ SCREW*

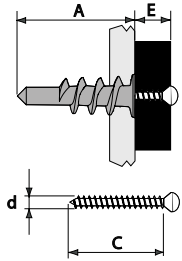

Articolo Code	A	d x C	E max	
<b>F1411</b>	38	4,5 x 30	12	100/2000



# GUIDA RAPIDA FISSAGGI PESANTI

## QUICK GUIDE TO HEAVY DUTY FIXINGS

Per facilitare e soprattutto per rendere il fissaggio più rapido e sicuro, la guida rapida fornisce la soluzione a qualsiasi problema o dubbio relativo al fissaggio. I fissaggi pesanti sono indicati per materiali compatti quali mattoni pieni, calcestruzzo e pietra naturale. Le tabelle tengono conto dei materiali di supporto, e della modalità di installazione.

*To facilitate and above all to make fixing quicker and safer, the quick guide provides the solution to any problem or doubt related to fixing. Heavy fixings are suitable for compact materials such as solid bricks, concrete and natural stone. The tables take into account support materials, and how to install them.*

### TIPOLOGIA DI MATERIALI

#### TYPE OF MATERIALS

#### COMPATTI · SOLID MATERIALS

Mattoni pieni  
Solid bricks



Calcestruzzo  
Concrete



Pietra naturale  
Natural stone



#### PASSANTI

##### THROUGH FIXINGS



pag.



278

TMP



280

TPP

#### NON PASSANTI

##### NON-THROUGH



282

TMN



285

TPN



Applicazione idonea  
Suitable application



Parzialmente indicato  
Partially suitable application



## ANCORANTE TMP

### TMP SLEEVE ANCHOR

Ancorante in acciaio per fissaggi pesanti di tipo passante. Studiato per una molteplicità di utilizzi consente un'elevata velocità di applicazione ed è particolarmente adatto per il fissaggio in materiali edili compatti. È ideale per carpenteria leggera, telai, profili e serramenti. La rondella larga garantisce una migliore distribuzione delle forze di serraggio.

## TMP

*Steel sleeve anchor for heavy duty through fixings. Designed for multiple uses, it offers high application speed and is particularly suitable for fixings in solid construction materials. It is ideal for light carpentry, frames, profiles and doors. The large washer guarantees a better distribution of the tightening forces.*

**Materiale:** acciaio zincato  
**Tipo di installazione:** passante

**Material:** galvanized steel  
**Type of installation:** through

### SEQUENZA DI FISSAGGIO · FIXING STEPS

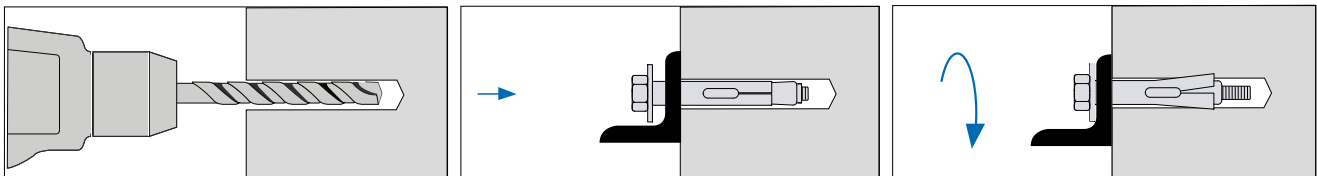

## CON VITE A TESTA ESAGONALE 6.8

WITH HEXAGONAL HEAD 6.8 SCREW

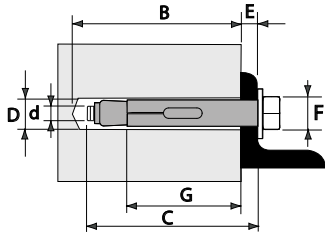

Articolo  
Code



	D	B	d x C	E max	F	G min	
<b>F3114</b>	8	65	M6 x 65	15	10	40	100/1000
<b>F3116</b>	8	90	M6 x 90	40	10	40	150/900
<b>F3126</b>	10	65	M8 x 65	10	13	45	50/500
<b>F3128</b>	10	90	M8 x 90	35	13	45	50/300
<b>F3137</b>	12	75	M10 x 75	10	17	50	50/300
<b>F3131</b>	12	115	M10 x 115	50	17	50	25/150

TMP

## ANCORANTE TPP

### TPP ANCHOR BOLTS

Ancorante in acciaio per fissaggi pesanti di tipo passante. È dotato di una fascetta di espansione, di un dado e di una rondella. L'ancorante TPP è il fissaggio passante ideale per carpenteria metallica. La profondità di inserimento può variare a seconda delle esigenze. La filettatura lunga rende il tassello TPP adatto per diversi spessori. La geometria della fascetta e della zona di espansione rendono possibile un fissaggio sicuro su calcestruzzo.

## TPP

*Steel anchor bolt for heavy duty through fixings. It comes with an expansion strap, a nut and a washer. The TPP anchor bolt is the ideal through fixing for metallic carpentry. The depth of insertion may vary depending on the needs. The long thread makes the TPP plug suitable for different thicknesses. The shape of the strap and the expansion area enable steady fixings on concrete.*

**Materiale:** acciaio zincato  
**Tipo di installazione:** passante

**Material:** galvanized steel  
**Type of installation:** through

### SEQUENZA DI FISSAGGIO · FIXING STEPS

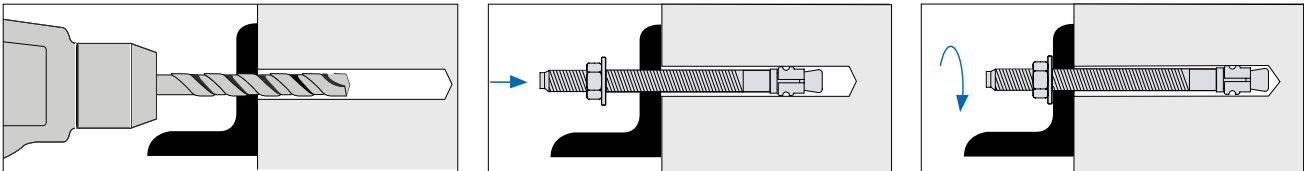

**PASSANTE IN ACCIAIO CON DADO E RONDELLA**  
 STEEL ANCHOR BOLT WITH NUT AND WASHER

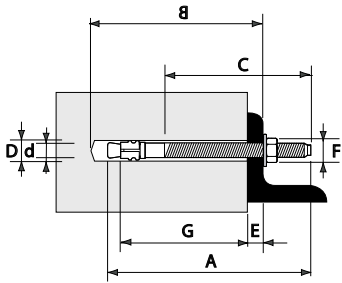

Articolo Code	D	A	B	d x C	E	F	G	
<b>F8003</b>	8	75	75	M8 x 45	9/22	13	48/35	50/50
<b>F8004</b>	8	100	100	M8 x 70	34/47	13	48/35	100/100
<b>F8005</b>	10	75	75	M10 x 35	3/11	17	50/42	
<b>F8006</b>	10	90	90	M10 x 45	18/26	17	50/42	
<b>F8007</b>	10	120	120	M10 x 80	48/56	17	50/42	25/25
<b>F8008</b>	12	95	95	M12 x 40	7/17	19	70/50	
<b>F8009</b>	12	110	110	M12 x 55	12/32	19	70/50	50/50
<b>F8010</b>	12	140	140	M12 x 90	52/62	19	70/50	20/20
<b>F8011</b>	16	125	125	M16 x 75	6/26	24	87/64	25/25
<b>F8012</b>	16	150	150	M16 x 100	31/51	24	84/64	10/10

TPP

# ANCORANTI TMN

## TMN HEAVY DUTY ANCHORS

È un tassello con 3 settori di espansione, interamente in acciaio, dotato di alette antirotazione e bugnature di aggrappo per assicurare una perfetta aderenza alle pareti del foro.

Il dado conico di riscontro è protetto da un tappo in materiale plastico per evitare che i detriti di foratura ne compromettano la filettatura interna.

È corredato di una vasta gamma di viti di diverse forme e dimensioni, che risolvono tutti i problemi di fissaggio nei molteplici campi d'utilizzo, assicurando prestazioni altamente affidabili.

*This 100% steel anchor has 3 expansion areas and comes with anti-rotation fins and gripping ribs to ensure perfect adherence to the walls of the hole. The conical nut is protected by a plastic cover to prevent the drilling debris from damaging the internal thread.*

*It comes complete with a wide range of screws in different shapes and sizes, which solve all fixing issues in any area of use, ensuring highly reliable performance.*

**Materiale:** acciaio zincato  
**Tipo di installazione:** non passante

**Material:** galvanized steel  
**Type of installation:** non-through

### SEQUENZA DI FISSAGGIO · FIXING STEPS

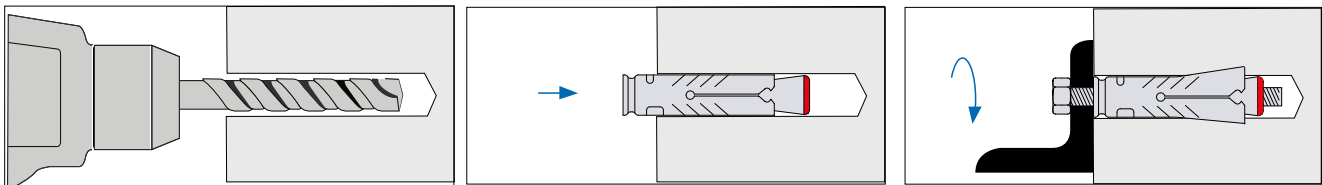

### ANCORANTE IN ACCIAIO STEEL ANCHOR

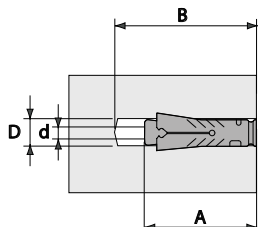

Articolo Code	D	A	B	d	
<b>F2001</b>	10	45	60	M6	100/100
<b>F2002</b>	12	50	65	M8	
<b>F2003</b>	15	60	80	M10	50/50
<b>F2004</b>	18	74	100	M12	25/25

TMN

### CON VITE A TESTA ESAGONALE 8.8 WITH HEXAGONAL HEAD 8.8 SCREW

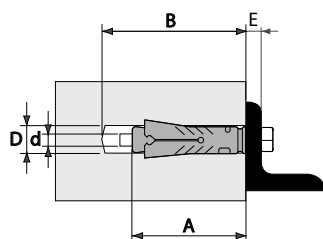

Articolo Code	D	A	B	d x C	E max	F	
<b>F2011</b>	10	45	60	M6 x 55	5	10	50/50
<b>F2012</b>	12	50	65	M8 x 60	5	13	
<b>F2013</b>	15	60	90	M10 x 85	10	17	
<b>F2014</b>	18	74	115	M12 x 105	20	19	15/15

TMN

### CON GANCIO 5.8 WITH 5.8 HOOK

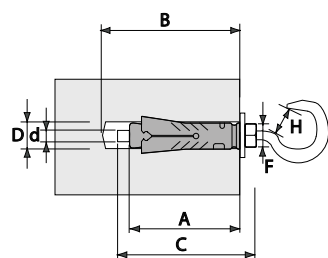

Articolo Code	D	A	B	d x C	H	F	
<b>F2031</b>	10	45	60	M6 x 55	8	10	50/50
<b>F2032</b>	12	50	65	M8 x 60	10	13	25/25
<b>F2033</b>	15	60	80	M10 x 73	12,5	17	15/15
<b>F2034</b>	18	74	100	M12 x 90	16	19	10/10

TMN

**CON OCCHIOLO 5.8**  
WITH 5.8 EYE HOOK

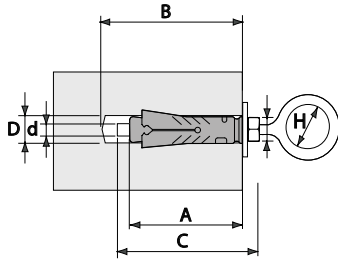

Articolo Code	D	A	B	d x C	H	F	
<b>F2051</b>	10	45	60	M6 x 55	10	10	50/50
<b>F2052</b>	12	50	65	M8 x 60	11	13	25/25
<b>F2053</b>	15	60	80	M10 x 73	14,5	17	20/20
<b>F2054</b>	18	74	100	M12 x 90	17	19	10/10

TMN

**CON BARRA FILETTATA**  
WITH THREADED ROD

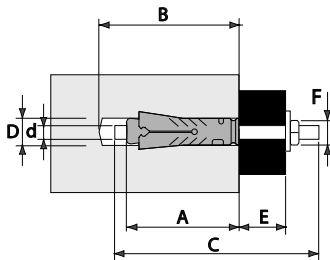

Articolo Code	D	A	B	d x C	E max	F	
<b>F2081</b>	10	45	65	M6 x 70	5	10	100/100
<b>F2082</b>	12	50	80	M8 x 85	10	13	25/25
<b>F2083</b>	15	60	100	M10 x 105	20	17	50/50
<b>F2084</b>	18	74	125	M12 x 130	25	19	25/25

TMN

## ANCORANTI TPN

### TPN HEAVY DUTY ANCHORS

È un ancorante in acciaio per fissaggi pesanti. Caratterizzato da due elementi in acciaio e dotato di alette laterali, è completato da un cono di espansione. È corredato di una vasta gamma di viti di diverse forme e dimensioni, che risolvono tutti i problemi di fissaggio nei molteplici campi d'utilizzo, assicurando prestazioni altamente affidabili.

Garantisce una tenuta ideale grazie alle alette laterali che evitano la rotazione durante l'espansione.

La filettatura del cono di espansione è protetta dalla polvere da un tappo in materiale plastico.

# TPN

*Steel anchors for heavy duty fixings. Featuring two steel elements and equipped with side fins, it is complemented by an expansion cone. It comes with a wide range of screws in different shapes and sizes, which solve all fixing issues in any area of use, ensuring highly reliable performance.*

*Preventing the anchor from turning during the expansion, the side fins guarantee a perfect hold.*

*A plastic cover protects from dust the thread of the expansion cone.*

**Materiale:** acciaio

**Tipo di installazione:** non passante

**Material:** steel

**Type of installation:** non-through

#### SEQUENZA DI FISSAGGIO • FIXING STEPS

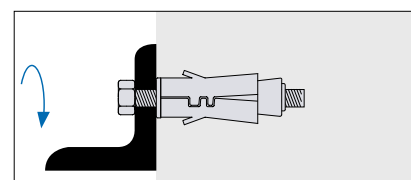
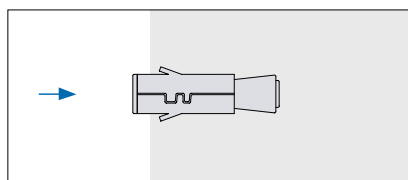
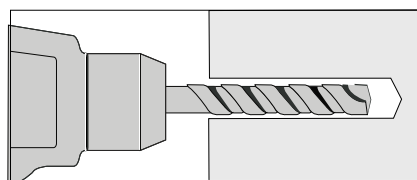



## ANCORANTE IN ACCIAIO

### STEEL ANCHOR

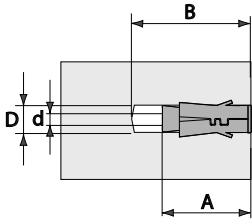

Articolo Code	D	A	B	d	
<b>F7001</b>	12	45	60	M6	100/100
<b>F7002</b>	14	50	65	M8	50/50
<b>F7003</b>	16	60	80	M10	
<b>F7004</b>	20	75	95	M12	25/25

TPN

## CON VITE A TESTA ESAGONALE 8.8 E RONDELLA MAGGIORATA

### WITH HEXAGONAL HEAD 8.8 SCREW AND LARGE WASHER

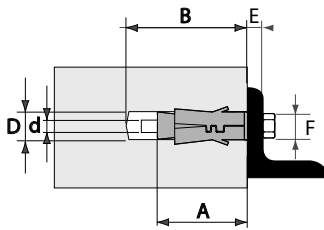

Articolo Code	D	A	B	d x C	E max	F	
<b>F7011</b>	12	45	60	M6 x 50	10	10	50/50
<b>F7012</b>	14	50	65	M8 x 60	10	13	25/25
<b>F7013</b>	16	60	85	M10 x 80	20	17	20/20
<b>F7014</b>	20	75	95	M12 x 90	20	19	10/10

TPN

## CON GANCIO 5.8 E RONDELLA MAGGIORATA

### WITH 5.8 HOOK AND LARGE WASHER

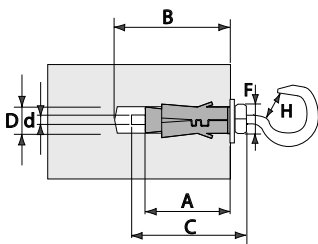

Articolo Code	D	A	B	d x C	H	F	
<b>F7031</b>	12	45	60	M6 x 55	8	10	50/50
<b>F7032</b>	14	50	65	M8 x 60	10	13	25/25
<b>F7033</b>	16	60	80	M10 x 73	12,5	17	10/10
<b>F7034</b>	20	75	95	M12 x 90	16	19	5/5

TPN

**CON OCCHIOLO 5.8 E RONDELLA MAGGIORATA**  
 WITH 5.8 EYE HOOK AND LARGE WASHER

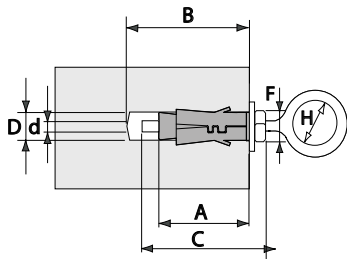

Articolo Code	D	A	B	d x C	H	E	
<b>F7051</b>	12	45	60	M6 x 55	10	10	50/50
<b>F7052</b>	14	50	65	M8 x 60	11	13	25/25
<b>F7053</b>	16	60	80	M10 x 73	14,5	17	10/10
<b>F7054</b>	20	75	95	M12 x 90	17	19	5/5

TPN

**CON BARRA FILETTATA 5.8 E RONDELLA MAGGIORATA**  
 WITH 5.8 THREADED ROD AND LARGE WASHER

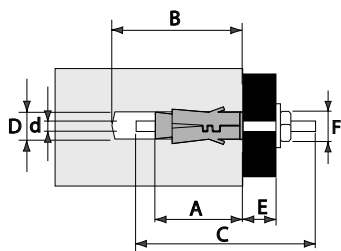

Articolo Code	D	A	B	d x C	E max	F	
<b>F7081</b>	12	45	60	M6 x 65	15	10	50/50
<b>F7082</b>	14	50	70	M8 x 75	20	13	25/25
<b>F7083</b>	16	60	80	M10 x 95	30	17	
<b>F7084</b>	20	75	100	m12 x 115	35	19	15/15

TPN

# GUIDA RAPIDA FISSAGGI CHIMICI

## QUICK GUIDE TO CHEMICAL FIXINGS

Per facilitare e soprattutto per rendere il fissaggio più rapido e sicuro, la guida rapida fornisce la soluzione a qualsiasi problema o dubbio relativo al fissaggio. I fissaggi chimici sono idonei per numerose applicazioni su supporti diversi. Le tabelle tengono conto di una serie di fattori, quali materiali di supporto, carichi applicati, tipologia dell'installazione, tipologie di ancorante, modi di foratura, e profondità di ancoraggio, tutti indispensabili per determinare il corretto tassello o ancorante.

*To facilitate and above all to make fixings quicker and safer, the quick guide provides the solution to any problem or doubt related to fixing. Chemical fixings are suitable for several applications on different supports. The tables take into account a number of factors, including support materials, applied loads, type of installation, types of anchor, drilling methods, and anchoring depth, all essential for determining the correct anchor or dowel.*

### TIPOLOGIA DI MATERIALI

#### TYPE OF MATERIALS

COMPATTI SOLID			FORATI PERFORATED		A BASSA RESISTENZA LOW RESISTANCE	
Mattoni pieni Solid bricks	Calcestruzzo Concrete	Pietra naturale Natural stone	Mattoni forati Perforated brick	Blocchi forati Perforated blocks	Calcestruzzo cellulare Cellular concrete	

ACCESSORI ACCESSORIES							pag.
 GN				●	●		289
 BFI		●	●	●	●	●	289
 BF		●	●	●	●	●	290
 GFA - GFO		●	●	●	●	●	290

● Applicazione idonea  
Suitable application

## ACCESSORI PER ANCORAGGI CHIMICI

### ACCESSORIES FOR CHEMICAL FIXINGS

#### TASSELLO A RETE GN

GN INJECTION ANCHOR SLEEVE

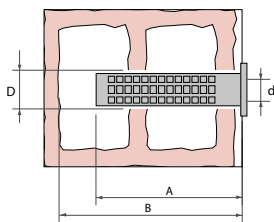

Articolo Code	D	A	B	d	
<b>F9401</b>	12	50	55	M8	10/40
<b>F9402</b>	15	85	95	M10	
<b>F9403</b>	15	130	140	M10	
<b>F9404</b>	20	85	95	M12	10/10

Compatibile con accessori filettati BF, GFA e GFO  
Suitable for BF, GFA, and GFO threaded accessories

#### BUSSOLA FILETTATA BFI

BFI INSIDE THREADED ANCHOR

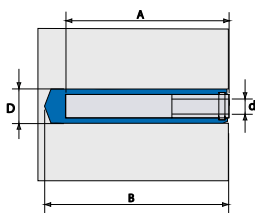

Articolo Code	D	A	B	d	
<b>F9502</b>	14	80	90	M8	100/100
<b>F9503</b>	16	80	90	M10	
<b>F9504</b>	12	80	90	M12	50/50

Compatibile con accessori filettati BF, GFA e GFO  
Suitable for BF, GFA, and GFO threaded accessories

### BARRA FILETTATA 5.8 BF

BF 5.8 THREADED ROD

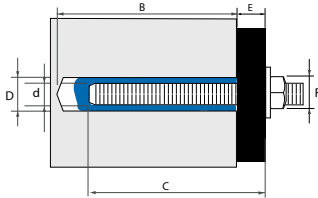

Articolo Code	D	B	d x C	E max	F
<b>F9082</b>	10	80	M8 x 100	10	13
<b>F9084</b>	12	90	M10 x 110	10	17
<b>F9085</b>	12	90	M10 x 135	35	17
<b>F9087</b>	14	110	M12 x 115	10	19



10/10

### GANCIO FILETTATO 5.8 GFA

GFA 5.8 THREADED HOOK

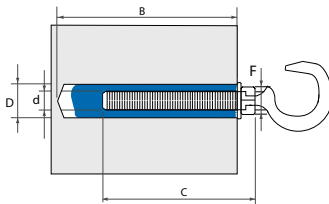

Articolo Code	D	B	d x C	F
<b>F9032</b>	10	65	M8 x 60	13 50/50
<b>F9033</b>	12	80	M10 x 73	17 25/25



### OCCHIOLO FILETTATO 5.8 GFO

GFO 5.8 THREADED EYE HOOK

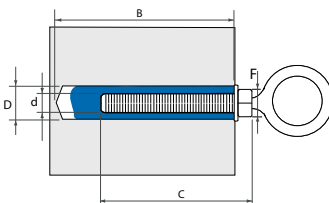

Articolo Code	D	B	d x C	F
<b>F9052</b>	10	65	M8 x 60	13 50/50
<b>F9053</b>	12	80	M10 x 73	17 25/25
<b>F9054</b>	14	95	M12 x 90	19 15/15



## CHIODATURA MANUALE

### MANUAL NAILING

#### CHIDO A PERCUSSIONE

##### IMPACT NAIL

Per fissaggi di bandelle pre-forate in acciaio o clip, senza preforatura

*For fixing clips or pre-perforated steel bands without pre-drilling.*



Articolo Code	Lunghezza Length	Diametro Diameter	
	m	Ø	
<b>F0531</b>	17	4	200/2000

#### PERCUSSORE PER CHIODI

##### IMPACT NAIL SETTING TOOL

Per l'applicazione di chiodi a percussione direttamente nel calcestruzzo. Alloggiamento con sfera di trattenimento chiodo. Impugnatura paracolpi, robusta ed ergonomica per la massima sicurezza di percussione. Testa trattata con speciale tempra anti-scheggia.

*For the application of percussion nails directly into the concrete. Housing with nail holding ball. Robust and ergonomic bumper grip for maximum percussion safety. Head treated with special anti-splinter quenching.*



Articolo Code		
<b>F0521</b>	520	5/5

#### BANDELLA IN TESSUTO

##### TEXTILE BAND

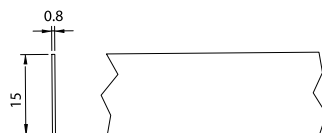

**MATERIALE:** polipropilene.

Per fissaggi di tubature a pavimento o sospese a soffitto.

**MATERIAL:** polypropylene.

For fixing pipes on the floor or hanging from the ceiling.

Articolo Code	Lunghezza Length	Carico rottura Breaking load	
	m	daN	
<b>F0511</b>	10	80	10/10

## BANDELLA IN METALLO PRE-FORATA

### PRE-PERFORATED METAL BAND

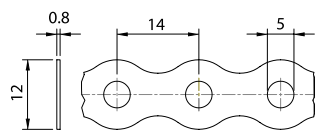

Per fissaggi di tubature a pavimento o sospese a soffitto.

For fixing pipes on the floor or hanging from the ceiling.

Articolo Code	Lunghezza Length	Carico rottura Breaking load	
	m	daN	
<b>F0501</b>	10	200	10/10

## ASSORTIMENTO BANDELLE CON CASSETTA DI PLASTICA

### TEXTILE BANDS KIT WITH PLASTIC CASE



Bandelle in tessuto 15x0,8 mm (n.10 x 10 m)  
 Chiodi a percussione in acciaio 17 mm (1.000 pz)  
 Percussore per chiodi  
 Martello da banco (300 g)  
 Cassetta di plastica

15x0,8 mm textile band (n. 10 x 10 m)  
 17 mm steel impact nails (1.000 pcs)  
 Impact nail setting tool  
 Hammer (300 g)  
 Plastic case

Articolo Code	Descrizione Description	
<b>F9904</b>	Assortimento bandelle e accessori per il fissaggio Textile bands and fixing accessories kit	1

# ELECTRICOL

Lisboa: Tel. +21 989 8930 Porto: Tel. 22 716 06 27

geral@electricol.pt

www.electricol.pt

<i>Código</i>	<i>Descrição</i>	<i>Material</i>	<i>PER</i>	<i>Unid.</i>	<i>Quant. Vendida</i>	<i>Preço Tabela Fev2023</i>
BM8069	BM FIX LINE CABINET	WALL PLUGS	1	PCE	1	1171,44
BMF0001	NYLON ANCHOR SUPER V 5	WALL PLUGS	100	PCE	100	3,31
BMF0002	NYLON ANCHOR SUPER V 6	WALL PLUGS	100	PCE	100	3,66
BMF0003	NYLON ANCHOR SUPER V 8	WALL PLUGS	100	PCE	100	7,02
BMF0004	NYLON ANCHOR SUPER V 10	WALL PLUGS	100	PCE	100	15,70
BMF0005	NYLON ANCHOR SUPER V 12	WALL PLUGS	100	PCE	25	24,31
BMF0011	NY ANCHOR SUPERV 5 + SCREW	WALL PLUGS	100	PCE	100	7,41
BMF0012	NY ANCHOR SUPER V 6 + SCREW	WALL PLUGS	100	PCE	100	11,28
BMF0013	NY ANCHOR SUPER V 8 SCREW	WALL PLUGS	100	PCE	50	17,01
BMF0014	NY ANCHOR SUPER V 10 SCREW	WALL PLUGS	100	PCE	25	31,79
BMF0021	ANCHOR SUPER V 5 HEAD SCREW	WALL PLUGS	100	PCE	100	11,77
BMF0022	ANCHOR SUPER V 6 HEAD SCREW	WALL PLUGS	100	PCE	100	12,40
BMF0023	ANCHOR SUPER V 8 HEAD SCREW	WALL PLUGS	100	PCE	50	19,55
BMF0032	ANCHOR SUPER V 6 OPEN EYE	WALL PLUGS	100	PCE	25	35,40
BMF0042	ANCHOR SUPER V 6 MEDIUM HOOK	WALL PLUGS	100	PCE	25	33,59
BMF0052	ANCHOR SUPER V 6 CLOSED EYE	WALL PLUGS	100	PCE	25	35,93
BMF0062	ANCHOR SUPER V 6 SHORT HOOK	WALL PLUGS	100	PCE	25	29,21
BMF0073	NYLON ANCHOR SUPER V 8 EXAG. SCREW	WALL PLUGS	100	PCE	50	63,37
BMF0074	NYLON ANCHOR SUPER V10 EXAG. SCREW	WALL PLUGS	100	PCE	25	104,21
BMF0092	ANCHOR SUPER V 6 SCREW 4X35 M6	WALL PLUGS	100	PCE	25	28,08
BMF0093	ANCHOR SUPER V 6 SCREW 5X45 M8	WALL PLUGS	100	PCE	25	47,47
BMF0101	ANCHOR NYLON TNV 6	WALL PLUGS	100	PCE	100	6,29
BMF0102	ANCHOR NYLON TNV 8	WALL PLUGS	100	PCE	100	7,17
BMF0103	ANCHOR NYLON TNV 10	WALL PLUGS	100	PCE	100	11,97
BMF0111	ANCHOR NYLON TNV 6 +SCREW	WALL PLUGS	100	PCE	100	10,72
BMF0112	ANCHOR NYLON TNV 8 +SCREW	WALL PLUGS	100	PCE	100	16,30
BMF0113	ANCHOR NYLON TNV 10+SCREW	WALL PLUGS	100	PCE	100	28,91
BMF0201	ANCHOR NYLON TNU 6	WALL PLUGS	100	PCE	100	16,42
BMF0202	ANCHOR NYLON TNU 8	WALL PLUGS	100	PCE	100	21,52
BMF0203	ANCHOR NYLON TNU 10	WALL PLUGS	100	PCE	100	33,66
BMF0211	ANCHOR NYLON TNU 6 +SCREW	WALL PLUGS	100	PCE	100	19,74
BMF0212	ANCHOR NYLON TNU 8 +SCREW	WALL PLUGS	100	PCE	100	35,08
BMF0213	ANCHOR NYLON TNU 10+SCREW	WALL PLUGS	100	PCE	100	58,67
BMF0311	ANCHOR NYLON TN 9+SCREW	WALL PLUGS	100	PCE	100	43,63
BMF0312	ANCHOR NYLON TN 12+SCREW	WALL PLUGS	100	PCE	100	39,71
BMF0331	ANCHOR NY TN 9 OPEN EYE	WALL PLUGS	100	PCE	100	49,64
BMF0332	ANCHOR NY TN 12 OPEN EYE	WALL PLUGS	100	PCE	50	58,89
BMF0341	ANCHOR NY TN 9 MEDIUM HOOK	WALL PLUGS	100	PCE	100	32,58
BMF0342	ANCHOR NY TN 12 MEDIUM HOOK	WALL PLUGS	100	PCE	100	42,97
BMF0351	ANCHOR NY TN 9 EYE	WALL PLUGS	100	PCE	100	36,44
BMF0352	ANCHOR NY TN 12 EYE	WALL PLUGS	100	PCE	50	47,08
BMF0361	ANCHOR NY TN 9 SHORT HOOK	WALL PLUGS	100	PCE	100	36,86
BMF0362	ANCHOR NY TN 12 SHORT HOOK	WALL PLUGS	100	PCE	100	37,66
BMF0381	ANCHOR NY TN 9 DOUBLE NUT	WALL PLUGS	100	PCE	100	42,97
BMF0382	ANCHOR NY TN 12 DOUBLE NUT	WALL PLUGS	100	PCE	50	53,92
BMF0411	ANCHOR STEEL TM 8+SCREW	WALL PLUGS	100	PCE	100	34,14
BMF0412	ANCHOR STEEL TM 9+SCREW	WALL PLUGS	100	PCE	100	41,88
BMF0431	ANCHOR STEEL TM 8 OPEN EYE	WALL PLUGS	100	PCE	100	41,82
BMF0432	ANCHOR STEEL TM 9 OPEN EYE	WALL PLUGS	100	PCE	50	51,19
BMF0441	ANCHOR STEEL TM 8 MEDIUM HOOK	WALL PLUGS	100	PCE	100	38,84
BMF0442	ANCHOR STEEL TM 9 MEDIUM HOOK	WALL PLUGS	100	PCE	100	45,85
BMF0451	ANCHOR STEEL TM 8 EYE	WALL PLUGS	100	PCE	100	42,21
BMF0452	ANCHOR STEEL TM 9 EYE	WALL PLUGS	100	PCE	50	50,52
BMF0461	ANCHOR STEEL TM 8 SHORT HOOK	WALL PLUGS	100	PCE	100	36,71
BMF0462	ANCHOR STEEL TM 9 SHORT HOOK	WALL PLUGS	100	PCE	100	44,98
BMF0481	ANCHOR STEEL TM 8 DOUBLE NUT	WALL PLUGS	100	PCE	100	41,38
BMF0482	ANCHOR STEEL TM 9 DOUBLE NUT	WALL PLUGS	100	PCE	50	52,56
BMF0501	METAL BAND 10 MT 12X0,8	WALL PLUGS	100	PCE	10	1343,17
BMF0511	TEXTIL BAND 10 MT 15X0,8	WALL PLUGS	100	PCE	10	535,84
BMF0521	IMPACT NAIL SETTING TOOL	WALL PLUGS	1	PCE	5	51,19
BMF0531	NAIL STEEL 4X17 MM	WALL PLUGS	100	PCE	200	9,06
BMF1014	STEEL TOGGLE AM SCREW M4	WALL PLUGS	100	PCE	100	70,97
BMF1034	STEEL TOGGLE AM OPEN HOOK	WALL PLUGS	100	PCE	100	74,23
BMF1054	STEEL TOGGLE AM CLOSED EYE	WALL PLUGS	100	PCE	100	74,60
BMF1084	STEEL TOGGLE AM DOUBLE NUT M4	WALL PLUGS	100	PCE	100	74,70



<i>Código</i>	<i>Descrição</i>	<i>Material</i>	<i>PER</i>	<i>Unid.</i>	<i>Quant. Vendida</i>	<i>Preço Tabela Fev2023</i>
BMF1136	STEEL TOGGLE AG OPEN HOOK M6	WALL PLUGS	100	PCE	50	93,66
BMF1186	STEEL TOGGLE AG DOUBLE NUT M6	WALL PLUGS	100	PCE	100	88,42
BMF1311	ANCHOR NY. SELFTHREAD VP SCREW	WALL PLUGS	100	PCE	100	17,39
BMF1411	ANCHOR ZINC ALLOY VM+SCREW	WALL PLUGS	100	PCE	100	55,12
BMF2001	ANCHOR STEEL TMN 6	WALL PLUGS	100	PCE	100	56,94
BMF2002	ANCHOR STEEL TMN 8	WALL PLUGS	100	PCE	100	67,09
BMF2003	ANCHOR STEEL TMN 10	WALL PLUGS	100	PCE	50	91,79
BMF2004	ANCHOR STEEL TMN 12	WALL PLUGS	100	PCE	25	118,06
BMF2011	ANCHOR STEEL TMN 6 SCREW	WALL PLUGS	100	PCE	50	90,53
BMF2012	ANCHOR STEEL TMN 8 EXAG.SCREW	WALL PLUGS	100	PCE	50	117,27
BMF2013	ANCHOR STEEL TMN10 EXAG.SCREW	WALL PLUGS	100	PCE	25	229,53
BMF2014	ANCHOR STEEL TMN12 EXAG.SCREW	WALL PLUGS	100	PCE	15	292,30
BMF2031	ANCHOR STEEL TMN 6 HOOK	WALL PLUGS	100	PCE	25	163,51
BMF2032	ANCHOR STEEL TMN 8 HOOK	WALL PLUGS	100	PCE	25	249,72
BMF2033	ANCHOR STEEL TMN10 HOOK	WALL PLUGS	100	PCE	10	317,70
BMF2034	ANCHOR STEEL TMN12 HOOK	WALL PLUGS	100	PCE	10	521,57
BMF2051	ANCHOR STEEL EYE TMN 6	WALL PLUGS	100	PCE	50	154,44
BMF2052	ANCHOR STEEL EYE TMN 8	WALL PLUGS	100	PCE	25	207,03
BMF2053	ANCHOR STEEL EYE TMN 10	WALL PLUGS	100	PCE	20	298,10
BMF2054	ANCHOR STEEL EYE TMN 12	WALL PLUGS	100	PCE	10	491,09
BMF2081	ANCHOR STEEL TMN 6 SCREW+NUT	WALL PLUGS	100	PCE	100	86,96
BMF2082	ANCHOR STEEL TMN 8 SCREW+NUT	WALL PLUGS	100	PCE	25	117,21
BMF2083	ANCHOR STEEL TMN10 SCREW+NUT	WALL PLUGS	100	PCE	50	192,19
BMF2084	ANCHOR STEEL TMN12 SCREW+NUT	WALL PLUGS	100	PCE	25	258,47
BMF3114	ANCHOR STEEL TMP 8 SCREW 6X65	WALL PLUGS	100	PCE	100	56,40
BMF3116	ANCHOR STEEL TMP 8 SCREW 6X90	WALL PLUGS	100	PCE	150	64,98
BMF3126	ANCHOR STEEL TMP10 SCREW 8X65	WALL PLUGS	100	PCE	50	85,46
BMF3128	ANCHOR STEEL TMP10 SCREW 8X90	WALL PLUGS	100	PCE	50	130,72
BMF3131	ANCHOR STEEL TMP12 -10X115	WALL PLUGS	100	PCE	25	153,25
BMF3137	ANCHOR STEEL TMP12 -10X75	WALL PLUGS	100	PCE	50	142,78
BMF7001	ANCHOR STEEL TPN 6 M6	WALL PLUGS	100	PCE	100	89,15
BMF7002	ANCHOR STEEL TPN 8 M8	WALL PLUGS	100	PCE	50	120,08
BMF7003	ANCHOR STEEL TPN10 M10	WALL PLUGS	100	PCE	50	182,54
BMF7004	ANCHOR STEEL TPN12 M12	WALL PLUGS	100	PCE	25	269,00
BMF7011	ANCHOR STEEL TMP 6 SCREW 6X50	WALL PLUGS	100	PCE	50	119,15
BMF7012	ANCHOR STEEL TMP 8 SCREW 8X60	WALL PLUGS	100	PCE	25	153,32
BMF7013	ANCHOR STEEL TMP10 SCREW 10X80	WALL PLUGS	100	PCE	20	247,26
BMF7014	ANCHOR STEEL TMP12 SCREW 12X90	WALL PLUGS	100	PCE	10	360,24
BMF7031	ANCHOR STEEL TPN 6 HOOK	WALL PLUGS	100	PCE	50	208,39
BMF7032	ANCHOR STEEL TPN 8 HOOK	WALL PLUGS	100	PCE	25	242,17
BMF7033	ANCHOR STEEL TPN10 HOOK	WALL PLUGS	100	PCE	10	352,68
BMF7034	ANCHOR STEEL TPN12 HOOK	WALL PLUGS	100	PCE	5	562,07
BMF7051	ANCHOR STEEL EYE TPN 6	WALL PLUGS	100	PCE	50	187,84
BMF7052	ANCHOR STEEL EYE TPN 8	WALL PLUGS	100	PCE	25	246,89
BMF7053	ANCHOR STEEL EYE TPN10	WALL PLUGS	100	PCE	10	326,95
BMF7054	ANCHOR STEEL EYE TPN12	WALL PLUGS	100	PCE	5	514,69
BMF7081	ANCHOR STEEL TPN 6 SCREW+NUT	WALL PLUGS	100	PCE	50	140,53
BMF7082	ANCHOR STEEL TPN08 SCREW+NUT	WALL PLUGS	100	PCE	25	189,75
BMF7083	ANCHOR STEEL TPN10 SCREW+NUT	WALL PLUGS	100	PCE	25	272,02
BMF7084	ANCHOR STEEL TPN12 SCREW+NUT	WALL PLUGS	100	PCE	15	408,26
BMF8003	ANCHOR STEEL TPP 8X75	WALL PLUGS	100	PCE	50	76,11
BMF8004	ANCHOR STEEL TPP 8X100	WALL PLUGS	100	PCE	100	85,01
BMF8005	ANCHOR STEEL TPP 10X75	WALL PLUGS	100	PCE	100	103,87
BMF8006	ANCHOR STEEL TPP 10X90	WALL PLUGS	100	PCE	25	105,68
BMF8007	ANCHOR STEEL TPP 10X120	WALL PLUGS	100	PCE	25	121,25
BMF8008	ANCHOR STEEL TPP 12X95	WALL PLUGS	100	PCE	25	133,60
BMF8009	ANCHOR STEEL TPP 12X110	WALL PLUGS	100	PCE	50	143,01
BMF8010	ANCHOR STEEL TPP 12X140	WALL PLUGS	100	PCE	20	185,42
BMF8011	ANCHOR STEEL TPP 16X125	WALL PLUGS	100	PCE	25	269,00
BMF8012	ANCHOR STEEL TPP 16X150	WALL PLUGS	100	PCE	10	290,61
BMF9032	HOOK OPEN M 8X60	WALL PLUGS	100	PCE	50	163,53
BMF9033	HOOK OPEN M 10X73	WALL PLUGS	100	PCE	25	255,01
BMF9052	STEEL EYE M 8X60	WALL PLUGS	100	PCE	50	152,80
BMF9053	STEEL EYE M 10X73	WALL PLUGS	100	PCE	25	203,81
BMF9054	STEEL EYE M 12X90	WALL PLUGS	100	PCE	15	323,91

<i>Código</i>	<i>Descrição</i>	<i>Material</i>	<i>PER</i>	<i>Unid.</i>	<i>Quant. Vendida</i>	<i>Preço Tabela Fev2023</i>
BMF9082	NUT BF 8X110 X RESIN	WALL PLUGS	100	PCE	10	<b>110,73</b>
BMF9084	NUT BF 10X110 X RESIN	WALL PLUGS	100	PCE	10	<b>136,06</b>
BMF9085	NUT BF 10X135 X RESIN	WALL PLUGS	100	PCE	10	<b>147,50</b>
BMF9087	NUT BF 12X115 X RESIN	WALL PLUGS	100	PCE	10	<b>225,83</b>
BMF9401	ANCHOR NET GN 12X50	WALL PLUGS	100	PCE	10	<b>39,89</b>
BMF9402	ANCHOR NET GN 15X85	WALL PLUGS	100	PCE	10	<b>39,89</b>
BMF9403	ANCHOR NET GN 15X130	WALL PLUGS	100	PCE	10	<b>65,48</b>
BMF9404	ANCHOR NET GN 20X85	WALL PLUGS	100	PCE	10	<b>65,48</b>
BMF9502	STEEL SLEEVE BFI 8	WALL PLUGS	100	PCE	100	<b>166,21</b>
BMF9503	STEEL SLEEVE BFI 10	WALL PLUGS	100	PCE	100	<b>151,07</b>
BMF9504	STEEL SLEEVE BFI 12	WALL PLUGS	100	PCE	50	<b>172,88</b>
BMF9904	KIT FIXING ELEMENT EN BANDE	WALL PLUGS	1	PCE	1	<b>208,26</b>



# ELECTRICOL

Distribuidor Profissional de Material Elétrico



---

## Sede

### LISBOA

Zona Industrial de Frielas  
Rua Cidade do Porto, Apartado 1063  
2661-852 Sto. António dos Cavaleiros  
PORTUGAL

Tel.: (351) 219 898 930

Email: [geral@electricol.pt](mailto:geral@electricol.pt)

N 38.81755°  
W 9.14478°

## Delegação Norte

### PORTO

Praceta Bartulomeu Dias, N216 Loja  
4410-454 Arcozelo - VNG  
PORTUGAL

Tel.: (351) 227 160 627

Email: [d.norte@electricol.pt](mailto:d.norte@electricol.pt)

N 38.81755°  
W 9.14478°

---

[www.electricol.pt](http://www.electricol.pt)